

ITEM NO.	QTY	PART No.	DESCRIPTION	LENGTH	ITEM NO.	QTY	PART No.	DESCRIPTION	LENGTH
21	1	W8-0590	DRUM SHAFT SPACER	7.1	1	1	W8-0101	WORMBOX HOUSING	
22	2		KEY - IMPERIAL	5/16" SQ x 1 7/8"	2	5	W8-0700	BUSH - WORMBOX HOUSING	31.8
23	1	W8-0251	DOG CLUTCH HOUSING		3	1	W8-0550	1 1/4" DRUM SHAFT - 12" DRUM	495.3
24	1	W8-0610	DOG CLUTCH - 1 1/4" SHAFT	45.0	4	2		KEY - IMPERIAL	5/16" SQ x 1.115"
25	1		1/4" BEARING BALL		5	1	W8-0440	WORMWHEEL HUB	28.6
26	1	W8-0631	DOG CLUTCH DETENT SPRING	0.33	6	1	W8-0420	WORMWHEEL	30.2
27	1		SOCKET SET SCREW 5/16"-18 UNC x 5/16"		7	1	W8-0802	WORMBOX COVER GASKET	0.8
28	1	W8-0270	DOG CLUTCH FORK		8	1	W8-0151	WORMBOX COVER	
29	1	W8-0271	DOG CLUTCH HANDLE	315	9	1	W8-0400	WORM - MECHANICAL	192.7
30	1		SPRING PIN 1/4" x 1 1/8"		10	2		ANGULAR CONTACT BALL BEARING 7304-B 20*52*15	
31	2		PLUG - HEX SOCKET	3/8" BSPT	11	1		KEY - IMPERIAL	3/16" SQ x 1 1/16"
32	1		BREATHER	3/8" BSPT	12	2	W8-0800	WORMSHAFT CAP GASKET	Ø83.3
33	1		GREASE NIPPLE 1/4" UNC 90 Degree		13	1	W8-0201	WORMSHAFT CAP - SEAL	
34	2		GREASE NIPPLE 1/4" UNC STRAIGHT		14	1	W8-0200	WORMSHAFT CAP - BLIND	
35	8		HEX HEAD BOLT 1/4"-20 UNC x 1"		15	1	CR7440	OIL SEAL	0.75x1.25x0.25
36	6	HHSS 0.3125-18x0.75	HEX HEAD SET SCREW 5/16"-18 UNC x 3/4"		16	1	CR12340	OIL SEAL	1.25x1.75x0.25
37	8	HHSS 0.3125-18x1	HEX HEAD SET SCREW 5/16"-18 UNC x 1"		17	2	W8-0640	DRAG BRAKE PAD	12
					18	2	W8-0641	DRAG BRAKE SPRING	
					19	1	W8-0503	WINCH DRUM - DN90 x 12"	304.8
					20	1		SOCKET SET SCREW 3/8"-24 UNF x 7/16"	

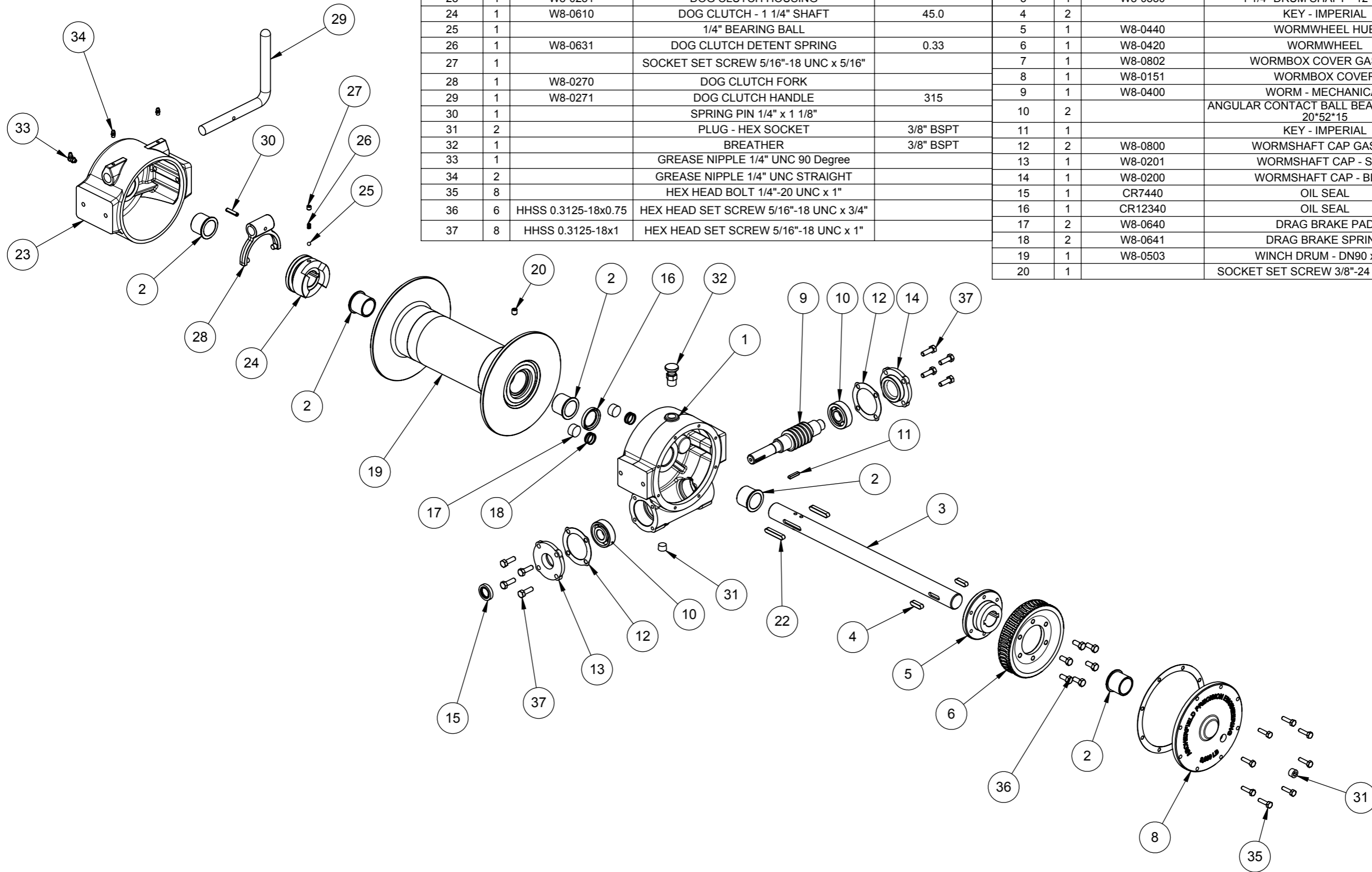

				ARCHERFIELD PRECISION ENGINEERING 2 COIN ST MOOROOKA QLD 4105 PHONE 07 3875 1568 FAX 07 3277 4316			DRAWN	RCT	21-07-09	8,000 LB WINCH		PROJECT No
							CHECKED			W8 MECHANICAL x 291 mm DRUM		
							DESIGNED			Ø3.5" x 12" DRUM		
							TECH APP			WITHOUT WORMBRAKE		SHEET 1 OF 1
							A.P.E. APP			SCALE	WEIGHT	DWG No
										1:7.5	27.1 Kg	- SHT - REV
												W8-0042-1-1
DWG No	REFERENCES	REV	DATE	DESCRIPTION	DRAWN	CHECK	APPD					
1		0	23/07/09	FIRST ISSUE	RCT							
		1	2/06/2010	UPDATED	RCT							

COPYRIGHT RESERVED. The design detailed on this drawing is the property of Archerfield Precision Engineering and must be returned on demand. It is issued on the strict condition that excepted to any third party, nor is it to be used for any purpose other than for which it was issued.